



OFFICE OF STATEWIDE HEALTH PLANNING AND DEVELOPMENT  
FACILITIES DEVELOPMENT DIVISION

APPLICATION FOR OSHPD PREAPPROVAL  
OF MANUFACTURER'S CERTIFICATION (OPM)

OFFICE USE ONLY

APPLICATION #: OPM-0477-13

OSHPD Preapproval of Manufacturer's Certification (OPM)

Type:  New  Renewal  Update to Pre-CBC 2013 OPA Number: \_\_\_\_\_

Manufacturer Information

Manufacturer: MIDMARK CORPORATION

Manufacturer's Technical Representative: Renee Browder

Mailing Address: 60 Vista Drive, Versailles, OH 45380

Telephone: (937) 526 - 8705 Email: RBrowder@midmark.com

Product Information

Product Name: Midmark Corporation Dental Phoenix Sink/Storage Combo

Product Type: Sink/Storage Cabinet

Product Model Number: 027-2092-00, 027-2092-01

General Description: Floor-supported cabinet

Applicant Information

Applicant Company Name: ZFA Structural Engineers

Contact Person: Ryan Bogart

Mailing Address: 601 Montgomery Street, Suite 1450, San Francisco, CA, 94111

Telephone: 415-243-4091 x202 Email: ryanb@zfa.com

I hereby agree to reimburse the Office of Statewide Health Planning and Development review fees in accordance with the California Administrative Code, 2016.

Signature of Applicant:  Date: 3/12/2018

Title: Senior Associate Company Name: ZFA Structural Engineers

"Access to Safe, Quality Healthcare Environments that Meet California's Diverse and Dynamic Needs"

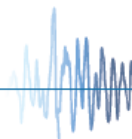



**OFFICE OF STATEWIDE HEALTH PLANNING AND DEVELOPMENT  
FACILITIES DEVELOPMENT DIVISION**

**Registered Design Professional Preparing Engineering Recommendations**

Company Name: ZFA Structural Engineers

Name: Mark Moore California License Number: S4443

Mailing Address: 601 Montgomery Street, Suite 1450, San Francisco, CA, 94111

Telephone: 415-243-4091 x201 Email: markm@zfa.com

**OSHPD Special Seismic Certification Preapproval (OSP)**

- Special Seismic Certification is preapproved under OSP-  
(Separate application for OSP is required)
- Special Seismic Certification is not preapproved

**Certification Method(s)**

- Testing in accordance with:  ICC-ES AC156  FM 1950-16
- Other\* (Please Specify): \_\_\_\_\_

\*Use of criteria other than those adopted by the California Building Standards Code, 2016 (CBSC 2016) for component supports and attachments are not permitted. For distribution system, interior partition wall, and suspended ceiling seismic bracings, test criteria other than those adopted in the CBSC 2016 may be used when approved by OSHPD prior to testing.

- Analysis
- Experience Data
- Combination of Testing, Analysis, and/or Experience Data (Please Specify): \_\_\_\_\_

**List of Attachments Supporting the Manufacturer's Certification**

- Test Report  Drawings  Calculations  Manufacturer's Catalog
- Other(s) (Please Specify): \_\_\_\_\_

**OFFICE USE ONLY – OSHPD APPROVAL VALID FOR CBC 2016 & ALL PRE-2016 CODE BASED PROJECTS**

Signature: Sonia Eliseo Date: 3/20/2019

Print Name: Sonia Eliseo

Title: SE

Condition of Approval (if applicable): \_\_\_\_\_

"Access to Safe, Quality Healthcare Environments that Meet California's Diverse and Dynamic Needs"

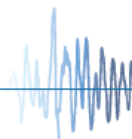



EQUIPMENT MANUFACTURER:  
MIDMARK CORPORATION

OPM-0477-13

**ZFA STRUCTURAL ENGINEERS**  
601 montgomery street | suite 1450 | san francisco ca 94111 | 415.243.4091 | zfa.com

DATE: 03/07/2018  
JOB NO.: 18005

SHEET  
**2**  
OF 3

EQUIPMENT TYPE:  
UNIT# 027-2092-00 & 027-2092-01 (PHOENIX SINK/STORAGE COMBO)

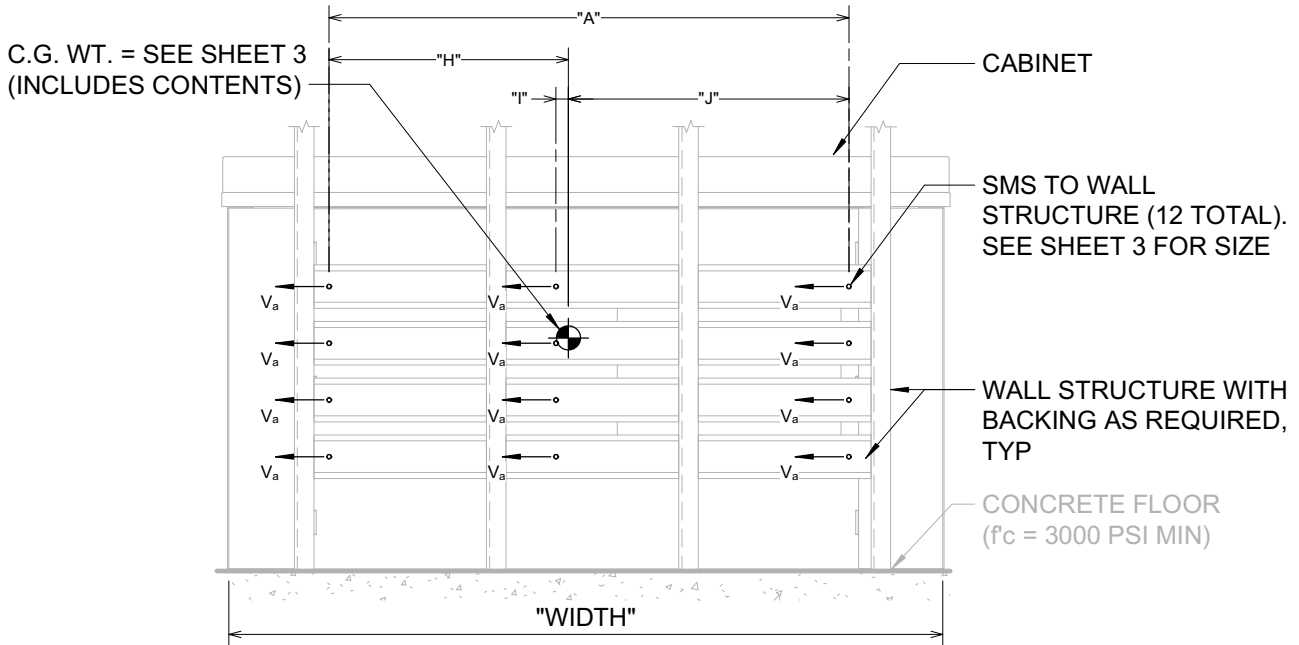

**FRONT ELEVATION**

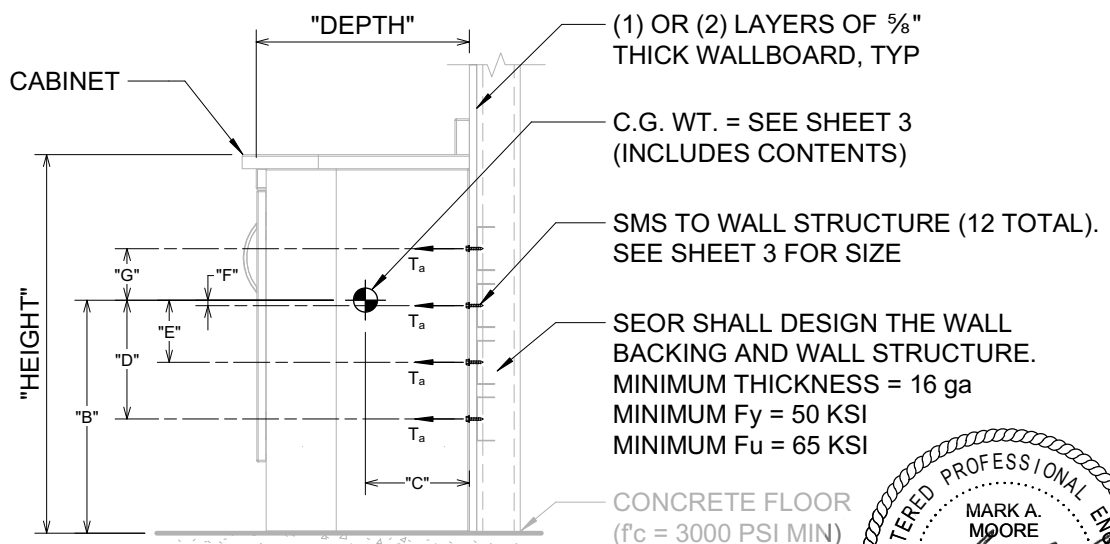

**SIDE ELEVATION**

**NOTES**

1. SEE SHEET 1 FOR GENERAL NOTES.
2. FOR UNIT GEOMETRY, WEIGHT, AND ANCHOR/ATTACHMENT FORCES, SEE SHEET 3. CENTER OF GRAVITY (CG) WEIGHT IS A MAXIMUM.
3. A SIGN MUST BE POSTED ON ALL CABINETS TO INDICATE THE TOTAL WT LIMIT NOT TO BE EXCEED.
4. MINIMUM SCREW SPACING =  $\frac{3}{4}$ "; MINIMUM EDGE DISTANCE FOR SCREWS =  $\frac{3}{8}$ "



EQUIPMENT MANUFACTURER:  
MIDMARK CORPORATION

**OPM-0477-13**

**ZFA STRUCTURAL ENGINEERS**  
601 montgomery street | suite 1450 | san francisco ca 94111 | 415.243.4091 | zfa.com

DATE: 03/07/2018  
JOB NO.: 18005

SHEET  
**3**  
OF 3

EQUIPMENT TYPE:  
UNIT# 027-2092-00 & 027-2092-01 (PHOENIX SINK/STORAGE COMBO)

**UNIT # 027-2092-XX**

UNIT # suffix	D (in)	E (in)	F (in)	G (in)	H (in)	I (in)	J (in)	UNIT "HEIGHT" (in) = 31.70					UNIT WT (lb)	MEDIA WT (lb)	TOTAL WT (lb)	MAX SCREW LOADING		SMS
								B (in)	UNIT "WIDTH" (in)	A (in)	UNIT "DEPTH" (in)	C (in)				T <sub>a</sub>	V <sub>a</sub>	
-00	10.1	5.3	0.6	4.1	19.0	1.05	24.5	19.7	60.0	43.5	17.8	8.6	278.7	258.6	537.3	109	50	#14
-01	10.1	5.3	0.6	4.1	24.5	1.05*	19.0	19.7	60.0	43.5	17.8	8.6	278.7	258.6	537.3	109	50	#14

\* mounts to the right of CG

**NOTE**

1. THIS PRE-APPROVAL ENCOMPASSES ALL WEIGHTS UP TO THE MAXIMUM SHOWN IN TABLE.
2. MEDIA WEIGHT IS CALCULATED ACCORDING TO BIFMA FUNCTIONAL LOADING GUIDLINES.  
(ANSI/BIFMA X5.9-2012: TABLE 1- TEST LOADS AS USED FOR SECTION 4 UNIT STRENGTH TESTS)
3. A SIGN MUST BE POSTED ON ALL CABINETS TO INDICATE THE TOTAL WT LIMIT NOT TO BE EXCEED.
4. SCREW LOADS ARE ASD VALUES.

**ISOMETRIC VIEW**

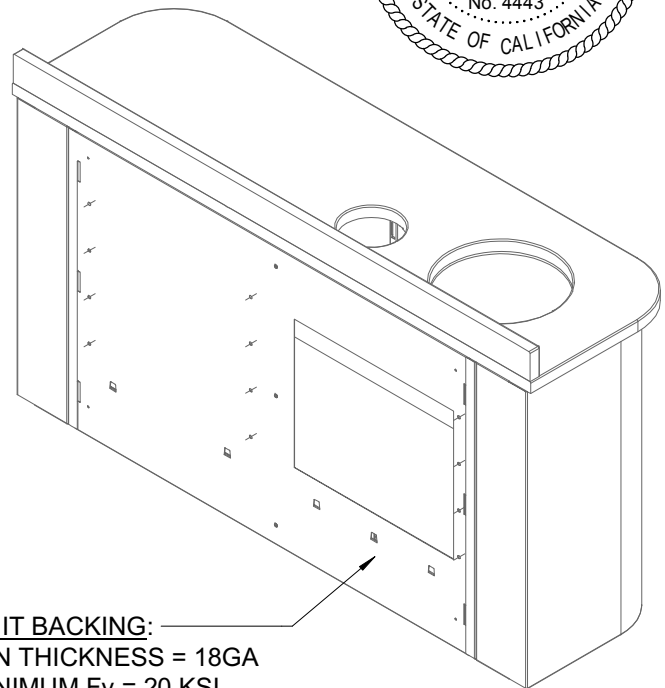
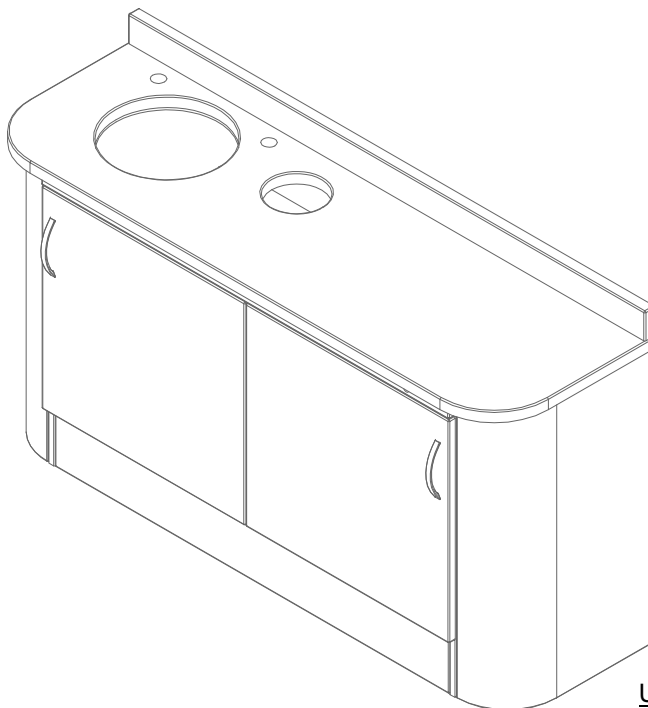

**UNIT BACKING:**  
MIN THICKNESS = 18GA  
MINIMUM F<sub>y</sub> = 20 KSI  
(ASTM A1008 CS TYPE B)

